

BOX S 404

FOUR CHANNEL TRANSMITTER

INSTRUCTION MANUAL



SMINN

innovative in electronics

MOTOR CONTROLLER USAGE RESTRICTION

Operation is not guaranteed when installed in different equipment than the specified.

THE USAGE INSTRUCTIONS OF THIS DEVICE SHALL BE HANDED TO THE USER, WHO WILL HAVE THEM IN THEIR POSSESSION. IF THEY ARE MISLAID, THE USER CAN ASK FOR A COPY OR DOWNLOAD IT DIRECTLY FROM THE WEBSITE WWW.SMINN.COM

The manufacturer keeps the right to modify the content of this document or the product without prior warning.
The equipment must be manipulated only by specialized and/or skilled personnel.

WARRANTY

This product has undergone a complete TEST during its manufacturing process that guarantees its reliability and proper operation. The manufacturer provides 24 months of warranty to the product from the date printed in the product and against any anomaly that it may present in its appearance or operation.
Any damage caused by third parties, natural causes (flooding, fire, lightning, etc), arising from improper handling or installation, vandalism or any other cause non attributable to the manufacturer will void the warranty. The warranty only covers repairs or replacement of the damaged device. Any expenses derived from assembling, travelling, transport, natural wear of parts, etc., and, in general, any expenses that are not part of the repairs or replacement of the damaged element of the system are excluded.
The installer/provider will ask the manufacturer for an RMA number or authorization for transport of the system in warranty. Without this previous requisite, the manufacturer will not be able neither to process nor provide warranty service.

WARNING

This product must be used in installations which has been conceived for, considering any other as improper use. The packaging and wrapping **MUST NOT** be dumped in the environment.
Keep products, packaging, wrapping, documentation, etc., out of the reach of children.
Follow the current local, national or European regulations. The information contained in this document may have some mistakes that will be corrected in future editions. The manufacturer keeps the right to modify the content of this document or the product without prior warning.

WASTE ELECTRICAL AND ELECTRONIC EQUIPMENT DIRECTIVE (WEEE)

In accordance with the European Directive 2002/96/EC about waste electrical and electronic equipment (WEEE), the presence of this symbol (see symbol at the bottom of this text) in the product or in the packaging, means that this article shall not be disposed in local non-classified waste streams. It is the user's responsibility to dispose this product taking it to a collection point designed for waste recycling of electrical and electronic devices.
The separate collection of this product helps optimize the waste sorting and recycling of any recyclable material and also decreases the impact on health and the environment.
For more information about the correct wasting of this product, please contact the local authority or the distributor where you acquired this product.



CE DECLARATION OF CONFORMITY

The company ELSON SISTEMAS, S. L.
Pol. Torrelarragoiti, P6 - A3 - 1ª
48170 Zamudio - Vizcaya (SPAIN)

Declares:

The product: BOX S 404 Transmitter
Manufactured by ELSON ELECTRÓNICA, S.A.
Under the trademark: **SMINN**
For use in: Residential, commercial or light industry environments.

This device meets the provisions contained in the article 3 of the R&TTE 1999/05/CE Regulation, as long as its usage is compliant to what was envisaged, having applied the following regulations:

Electromagnetic compatibility: 2004/108/CE
Low tension: 2006/95/CE
FCC Regulations Part 15 Low Power Transmitters (1)

(1) This equipment must endure any external radio-electrical interference and should not cause any detrimental interference to other systems.
Meeting the provisions of this regulation, any modification or adjustment to the product that may alter its characteristics or the functionality it has been developed for are entirely prohibited.

Zamudio, 2011.04.12

José Miguel Blanco Pérez
Chief Technical Officer

SMINN

innovative in electronics

Elson Sistemas

T. +34 944 525 120
www.sminn.com
info@sminn.com
Pol. Torrelarragoiti, P6 A3 - 1ª
48170 Zamudio Bizkaia
SPAIN

Rev2913

DESCRIPTION

SMINN Four Channel Transmitters are developed with state-of-the-art electronics and technology and make use of a robust anticopy system. They provide a high degree of operating reliability and security. They are designed to send the activation/desactivation order to SMINN receivers that are part of motor controllers, alarm systems, access control systems, home automation systems, etc.

Devices that are built using high quality materials and components and the latest technology. They are made taking into account the current regulations for the usage in residential, commercial and light industry environments.



OPERATION

When inputs C1/C4 are activated on 5/9 terminal block the transmitter sends a ciphered 72 bits data frame only decipherable by a SMINN receiver with high security Evolutive Cryptocode technology. Each transmitter has a unique serial number that distinguishes it from the rest and a PIN code that ensures usage with receivers with the same PIN code. The PIN code can only be modified via SMINN programming tools. PIN codes increase the security and simplify the delivery of transmitters to the final user, avoiding the need to actually go to the installation site. The receiver must be configured to accept transmitters this way.

TRANSMITTER PROGRAMMING

To register transmitters manually, proceed as follows:

- Turn on the transmitter and receivers and wait 5 sec.
- Press and hold the receiver's programming button (PROG)
- Press and hold the button of the transmitter's channel we want to register: C1, C2, C3, C4
- Check that the led is blinking in the receiver (SCAN mode).
- Wait for the validation beep in the receiver
- Release the transmitter button
- Release the programming button of the receiver (PROG).

Repeat this process for each receiver you want to program. It is recommended to program the transmitters and receivers before installation.

INSTALLATION

SMINN's motor controller is ready to be easily fixed on a wall using the supplied wall plugs and screws. Before connecting or operating the device, the power supply switch or differential shall be disconnected. Specialized and/or skilled personnel will do the installation, using properly protected cable of enough gauge and taking into account that devices permanently connected to the mains need to have an accessible connection device (i.e. a magnetothermic switch). The wiring should be done following the instructions printed in the serigraphy of the circuit board. After programming and verifying the equipment, place the lid on the front of the box, with the supplied screws.

SMINN'S MOTOR CONTROLLERS INCLUDE A LIGHT SIGNAL TO KNOW IF THE EQUIPMENT IS POWERED.

Note: Reinforced concrete, metallic components and/or any other receiving device reduce dramatically the radiofrequency signal, so installation close to these elements should be avoided.

TECHNICAL CHARACTERISTICS

BOX S 404	230V AC (125V Optional)/ 12-24V AC/DC
Power supply	AC o DC (NOT simultaneously)
Consumption	< 5 W
Frequency	433.92 MHz +- 75KHz
Encoding	Evolutive Crypto Code 72 bits
Radiated power	< 10 mW
Range outdoors	Until 200m
Nominal range	100m
Máx distance	> 200 m
Protection rating	Ip54 - (IP66 with cable glands)
Operating temperature	-20°C - +65° C
Size	100 x 130 x 50 mm
Casing	ABS

Fig. 1

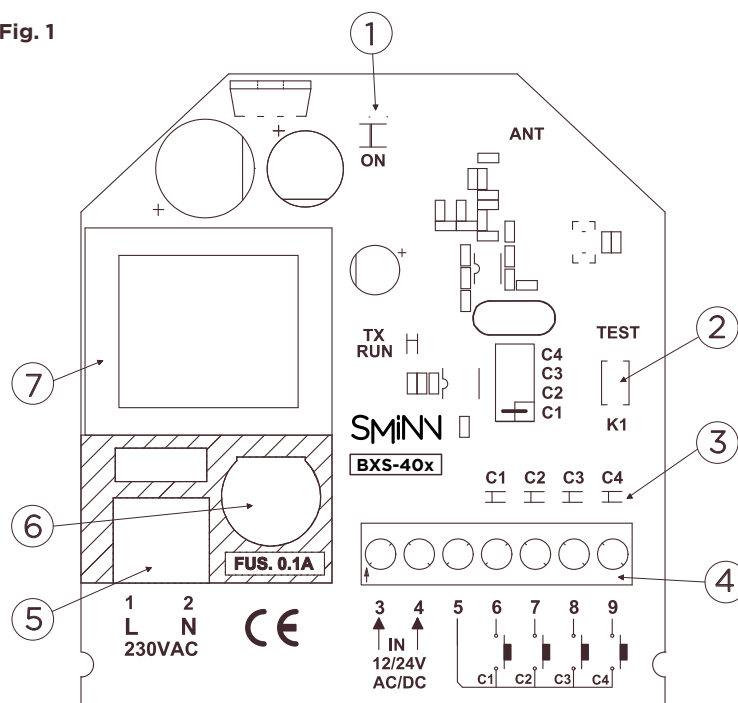

TYPICAL INSTALLATION

* Receivers can be: BOX S - TRSH - SATM

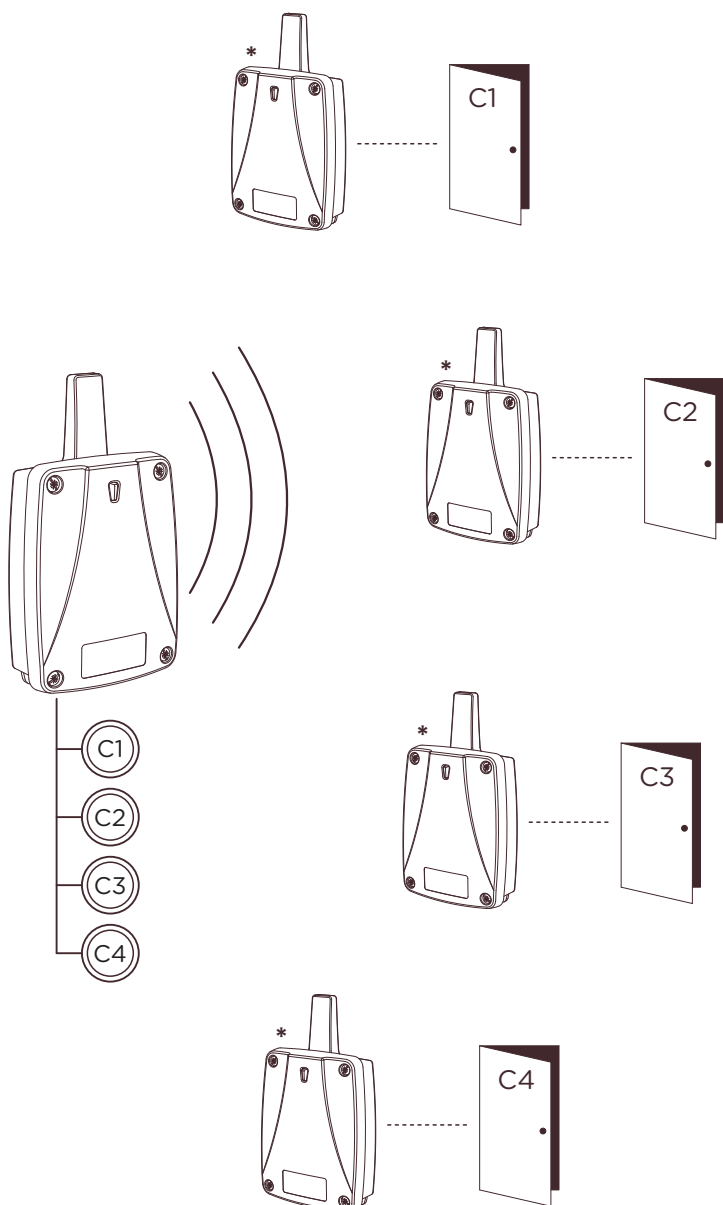

COMPONENTES

1. ON Led
2. TEST button (Default send Channel 1)
3. Status leds
4. Inputs and 12/24V AC/DC power input terminal block
5. 230V AC terminal block
6. Fuse
7. Transformer (depending model)

